

Adaptalock®

INTRODUCING THE **NEW**

UNIVERSAL MULTIPOINT LOCK

SLIDE. MATCH. LOCK. SIMPLE!



- X NO CUTTING**
- X NO NEW KEEPS**
- X NO HASSLE**

Full range of single/twin spindle gearboxes.

Up & down hook directions available.

Van stock kits available providing all bolt directions and the most common gearboxes.



JMA®
UNITED KINGDOM



MADE IN THE UK





TRADE INSTALLER

uPVC / Composite Upgrader Universal Hook Bolt System
The fully versatile and compact 3-piece system for trade installers!

Hook Bolt Rail & Faceplate Kit 16/20mm



With 4 Gearbox options



35 Backset Single Split Spindle



45 Backset Single Split Spindle



35 Backset Twin Spindle

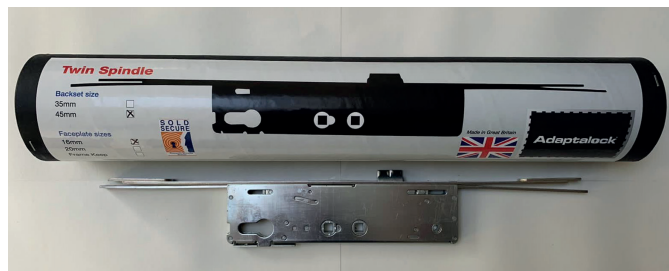

45 Backset Twin Spindle



TRADE INSTALLER / RETAILER & D.I.Y

One Piece Universal Hook Bolt Locking System

For uPVC and Composite Doors 16/20mm Faceplates



With 3 Gearbox options



35 Backset Single Split Spindle



35 Backset Twin Spindle



45 Backset Twin Spindle

- Faceplate can be snapped down to match the length of door
- Fully adjustable Hook Bolt positioning
- Hook Bolt casing can be changed from top to bottom to reverse Hook Bolt direction if necessary.

ACCESSORIES



Latch/Deadbolt Keep
Code: LDB left/Right



Pair of Long Adjustable
Hook Bolt Keeps uPVC
Code: LAHBK



Pair Hook Bolt Keeps
Wooden Doors
Code: HBKT



Short Adjustable Hook
Bolt Keep uPVC
Code: SAHBK



Compression Cam Keep
Code: CCK1



Compression Cam Keep
Code: CCK2

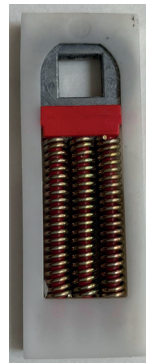

Handle Spring Cassette
Code: SCPAIR

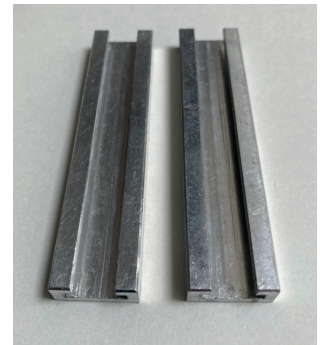

Faceplate Snapping Tool
Code: STPAIR



Pair of Compression
Cams
Code: CCP



Pair of Snap Down
Faceplates
Code: SDFPAIR



Bag of 50 uPVC Screws
Code: S32/50

uPVC/ COMPOSITE DOOR HANDLES & CYLINDERS



92PZ 212mm Bolt
Centres – Chrome
Code: 92/212LLC



92PZ 212mm Bolt
Centres – White
Code: 92/212LLW



92PZ 122mm Bolt
Centres – Chrome
Code: 92/122LLC



92PZ 122mm Bolt
Centres – White
Code: 92/122LLW



92/62PZ 212mm Bolt
Centres – Chrome
Code: 92/62 212LPC

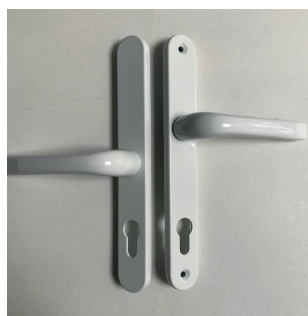

92/62PZ 212mm Bolt
Centres – White
Code: 92/62 212LPW



92/62PZ 212mm Bolt
Centres – Brass
Code: 92/62 212LPB



All sizes
Code:
Double __ x __ (size in mm)
Single __ x 10mm
Thumb turn __ x __
All Dual Finish.



Split Spindles
Code: SSKF

INSTALLATION GUIDE



1

Check door alignment with frame. Adjust hinges if necessary.



2

Mark door with a pencil adjacent to the frame keep bolt positions.



3

Remove existing system. Remove any plastic burrs created by the fixing screws of the existing system. Select the **Adaptalock** gearbox to match i.e. single/twin spindle and correct back set size.



4

Install gearbox, existing door furniture and cylinder.



5

Test alignment with the existing frame keep, adjust position or replace with universal keep if necessary.

With door open, lift handle and lock with key.



6

Undo the faceplate screws approximately 5mm. Disengage hook casing from twin rails by gently pulling casing away from the rails a few millimetres.

Holding the rail twin studs level with the holes on the gearbox drive arm, slide the hook casing along the twin rails so that the hook is between the pencil marks, slightly off centre allowing for the bolt swing. Push hook casing back onto rails and tighten faceplate screws.



7

Use a Bradawl to lift the Gearbox drive arm and position rail studs underneath.



8

Install the top drive, making sure the rails are fully driven in the locked position, using 1x Screw in the lower hole of the top tab.



9

Take a length of **Adaptalock** snap down face plate and align between the hook casing and gearbox, facing arrows together. Snap the face plate using the pair of snapping tools or pliers.

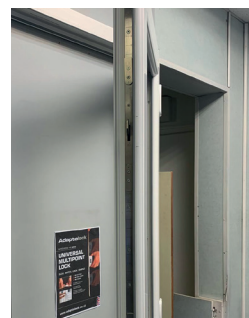

10

Install faceplate and fit screws in tabs.

11

Repeat for bottom drive rail.

NOTE: The current hook bolt directions can be reversed by removing the hook casings from the faceplates and switching them from top to bottom of system. For any further assistance please contact info@adaptalock.co.uk

ADAPTALOCK ONE-PIECE FULL-LENGTH SYSTEM INSTALLATION INSTRUCTIONS

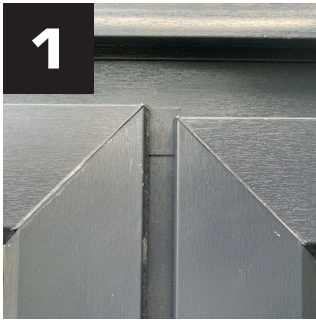

Check door alignment with frame. Adjust hinges if necessary.

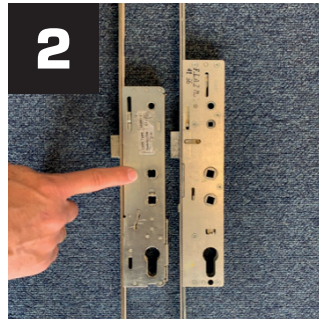

Remove existing system. Select the **Adaptalock** system with matching gearbox option. With both systems in unlocked position, align systems using the highest spindle hole from the cylinder hole in the gearbox.

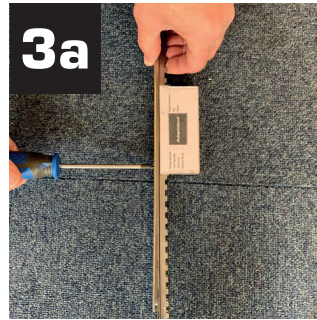

Loosen hook faceplate screws 5mm.

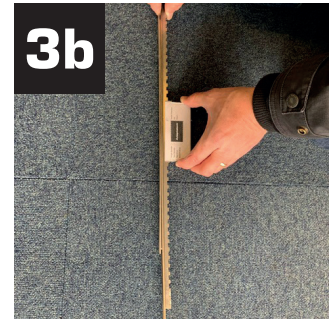

Pull hook bolt casing away slightly from the toothed rails and slide casing along the slotted plate until the hook bolts align.

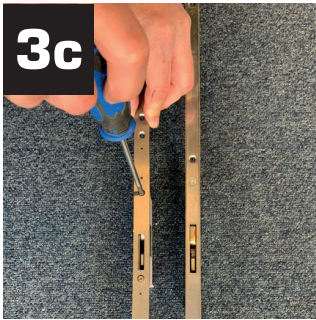

Re-engage hook casing to the toothed rails, making sure the hook is fully retracted by moving casing on rails, then tighten screws.

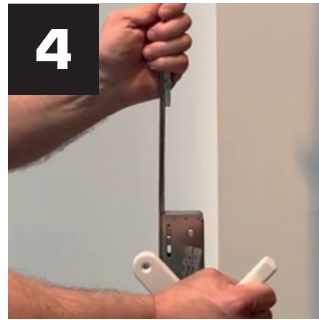

Repeat for bottom hook bolt casing alignment. Test operation of system.

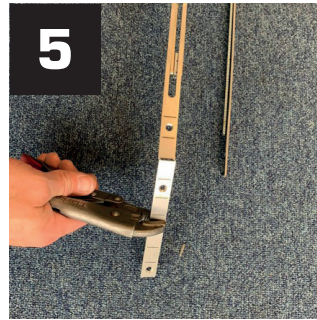

Shorten top/bottom of slotted plate using pliers at the snapping points.



Remove screw plastic burrs in the door.



Place system in door, installing the cylinder and handles. Install the countersunk screws provided in all countersunk holes in slotted plate and hook bolt faceplates (lower torque setting on battery screwdrivers to avoid over tightening screws).

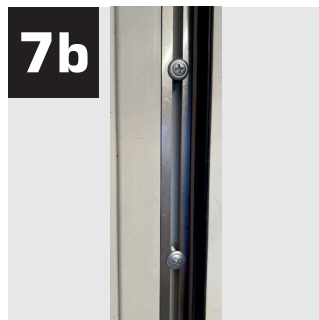

Test system with door open. Install wafer head screws provided into slotted plate as required.



Test operation of system with door closed.

If bolts are not engaging properly, mark all bolt positions with a pencil against the frame and make adjustments to keep positions. (It may be necessary to remove any plastic casings attached to the hook bolt keeps to allow full movement of hooks.)

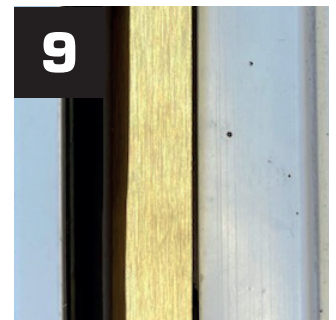

Install optional rail cover faceplates if required.

Adaptalock[®]

European Patent 3306019

www.jma-uk.co.uk



MADE IN THE UK

